

Customer approval :

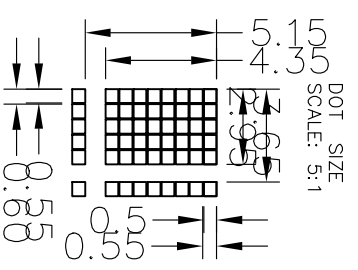
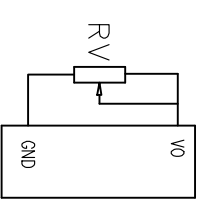
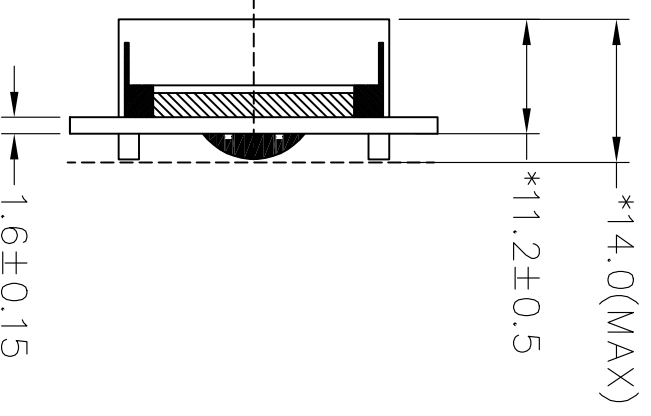
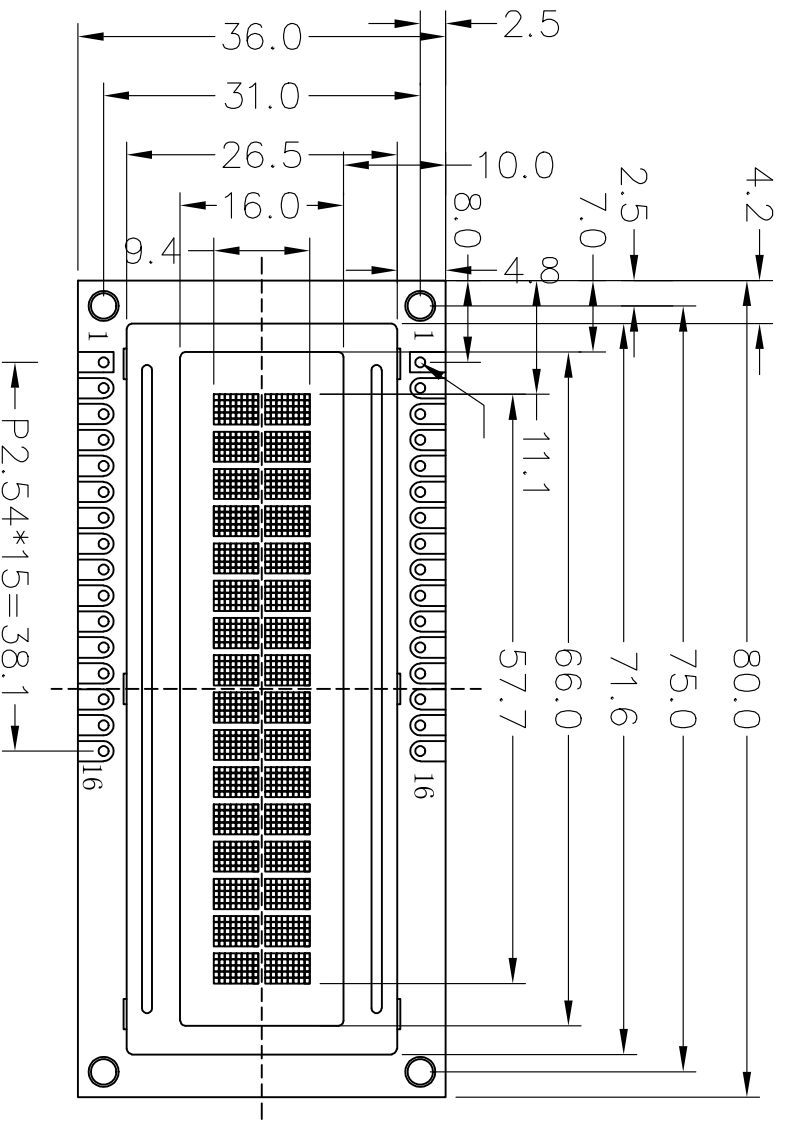

SPECIFICATION:

- 1). Driving: Duty:1/16, Bias:1/5, Vdd:5.0V, Vcd:4.5V
- 2). VIEWING DIRECTION: 6 O'CLOCK
- 3). Display mode: STN/Negative/Transmissive/Blue
- 4). Operating temp.: 0°C~+50°C
- 5). Storage temp.: -10°C~+60°C
- 6). Control IC: SPLC780D1(Or Compatible)
- 7). BACKLIGHT: EDGE, White(2DICES,ILED=30mA, VF=3.1V)
- 8). DIMENSIONS WITH MARK "*" ARE IMPORTANT WITH MARK "()" ARE REFERENCED
- 9). All the raw materials are RoHS compliant

1	2	3	4	5	6	7	8	9	10	11	12	13	14	15	16
VSS	VDD	Vo	RS	W/R	E	DB0	DB1	DB2	DB3	DB4	DB5	DB6	DB7	BLA	BLK

REV	REVISION RECORD	DATE	深圳市三元晶科技有限公司 Shenzhen TCCLCD HI-Tech Co., Ltd.		
A	FIRST ISSUE	2010-09-09	MODEL NO. 模组型号	SYB1602A2V/10-5C/10BL-B5NG	GENERAL TOL: 未注公差
B			APPROVED BY 审核	CHECKED BY 检查	±0.3
C			Liu	Francis	UNIT: 单位:mm
D			2010/09/09	2010/09/09	PROJECTION 三角法

